

COPPER FORK CABLE LUG

CRIMPING TYPE INSULATED TINNED COPPER FORK CABLE TERMINAL END WITH METAL REINFORCEMENT

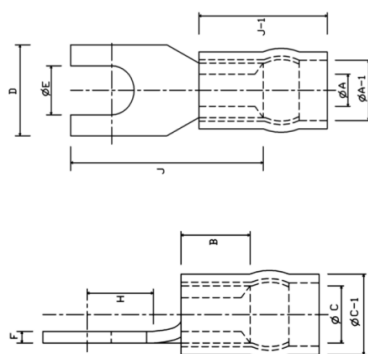

PESSRL Fork cable lugs with MR (Modified Rubber) insulation are engineered for superior performance in demanding electrical environments. These lugs are widely used in industrial machinery, automotive wiring, and electrical panels, where they provide a secure connection to terminals, bus bars, or studs.



- All the terminals are tin plated to avoid oxidation and to achieve maximum corrosion protection.
- The insulation sleeve, often made from PVC, protects against moisture, chemicals, and abrasion, ensuring long-lasting performance and reliability in diverse environments.
- Material: Copper (ETP) IS 1897
- Finish: Electro tin to BS 1872 (1984)
- Color coding of insulation sleeve

■ 1.5
 ■ 2.5
 ■ 4-6

Nominal Cross Section mm ²	PESSRL CAT NO.	Size of Bolt Die	A	C	D	F	B	H	J	C-1	J-1	L-3	COLOR
1.5	PESFR-7935	3.5	1.6	3.2	1.9	0.8	5	10	17	4.8	3.6	5.4	
	PESFR-7936	3	1.6	3.2	3.1	0.8	5	10	17	4.8	3.6	5.4	
2.5	PESFR-7937	3.5	2.3	3.9	1.9	0.8	5	10	17	5.5	4.4	6	
	PESFR-7938	5	2.3	3.9	1.9	0.8	5	17	24	5.5	4.4	6	
4-6	PESFR-1125	4.2	2.3	3.9	3.1	0.8	5	10	17	5.5	4.4	6	
	PESFR-7939	3	2.9	4.9	2.7	1	6	10	20	7.1	6.4	8.6	
	PESFR-7940	3.5	3.6	5.6	5.1	1	6	10	20	7.1	6.4	8.6	