

ALUMINIUM TUBULAR CABLE CONNECTOR

TUBULAR CABLE LONG BARREL CONNECTOR FOR XLPE CABLE

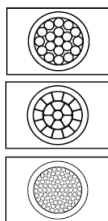

The PESSRL Aluminum long barrel connectors for XLPE cables are engineered to provide durable and efficient electrical connections in high-performance cable systems. These connectors are specifically designed for use with cross-linked polyethylene (XLPE) insulated cables, which are known for their excellent thermal and electrical properties. The long barrel design ensures a secure and reliable crimping over the entire length of the cable, accommodating various cable sizes and providing a strong mechanical and electrical bond. Constructed from ETP grade copper with a purity of 99.96%, it boasts a minimum conductivity of 60% IACS.

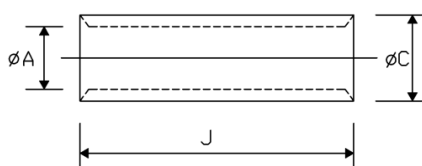

- Their compatibility with XLPE cables enhances the overall performance and longevity of the connection, ensuring stable operation in demanding environments.
- Aluminum long barrel connectors are perfect for use in power distribution networks, industrial machinery, and other high-current applications where reliability and performance are critical.
- Item identification on cable terminal
- These connectors are provided with a specialized corrosive compound that protects against moisture, oxidation, and other environmental elements, ensuring a long-lasting, corrosion-resistant connection
- Material - Aluminium 5082

Nominal Cross Section mm ²	PESSRL CAT NO.	d1	d4	l
25	PESAXF-25	7.2	9.6	82
35	PESAXF-35	8.3	11.1	90
50	PESAXF-50	10.1	13.5	100
70	PESAXF-70	10.2	14.5	104
95	PESAXF-95	12	16.9	108
120	PESAXF-120	13.7	19	112
150	PESAXF-150	15.1	21.2	116
185	PESAXF-185	16.6	23.9	128
225	PESAXF-225	18.6	26.1	136
240	PESAXF-240	19.3	27.2	140
300	PESAXF-300	21.8	30.2	150
400	PESAXF-400	25	34.8	150
500	PESAXF-500	28.2	39.1	175
630	PESAXF-630	31.7	44.4	200
800	PESAXF-800	35.7	49.5	225
1000	PESAXF-1000	41	56	250