

ALUMINIUM TUBULAR CABLE LUGS

TUBUALR CABLE TWO HOLE LUGS

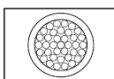

The PESSRL Aluminum two-hole lugs are designed to provide secure and efficient electrical connections in various industrial and commercial applications. Ideal for use in power distribution systems, heavy machinery, and electrical panels, these lugs feature a dual-hole configuration that allows for a reliable connection to terminals, bus bars, or mounting points. Constructed from ETP grade copper with a purity of 99.96%, it boasts a minimum conductivity of 60% IACS.

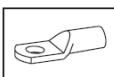
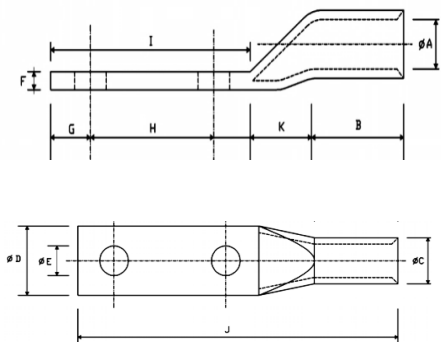

- The two-hole design facilitates a stable and robust connection by distributing mechanical stress across multiple points, enhancing the overall reliability and performance of the electrical system.
- Item identification on cable lug
- Material - Aluminium IS 5082

Nominal Cross Section mm ²	PESSRL CAT NO.	Size of Bolt Die	A	C	D	F	B	G	H	K	I	J
25	PESALPD-25	8.2	7	9.7	13.7	2.7	21	11	20	-	-	70
35	PESALPD-35	8.2	8	10.8	15.4	2.8	21	11	20	-	-	70
50	PESALPD-50	10.3	9.3	13	20	3.5	30	13	40	20	65	115
70	PESALPD-70	10.3	11.6	16	24	4.4	30	13	40	20	65	115
95	PESALPD-95	10.3	12.9	17.1	25	4.2	30	13	40	20	65	115
120	PESALPD-120	13	15	19.6	28	4.6	50	20	40	14	81	145
150	PESALPD-150	13	16.5	21.5	31	5.3	50	20	40	16	90	156
185	PESALPD-185	13	18.5	24	34	6	50	20	40	16	90	156
240	PESALPD-240	13	21	27	39	6	50	20	40	16	90	156
300	PESALPD-300	13	24	31	44	6.8	50	20	40	16	90	156